

Because of a more uniform load around the base of the building, temporary foundations are possible on Kelly buildings. The unique temporary foundation options shown here have been successfully used in numerous projects. Some were sold as a special feature with Kelly Klosure buildings, others were fabricated locally by the customer. In all cases, a Kelly technical representative provided design input. These options allow a temporary or special use building to be quickly installed on existing conditions without having to pour a new concrete foundation.

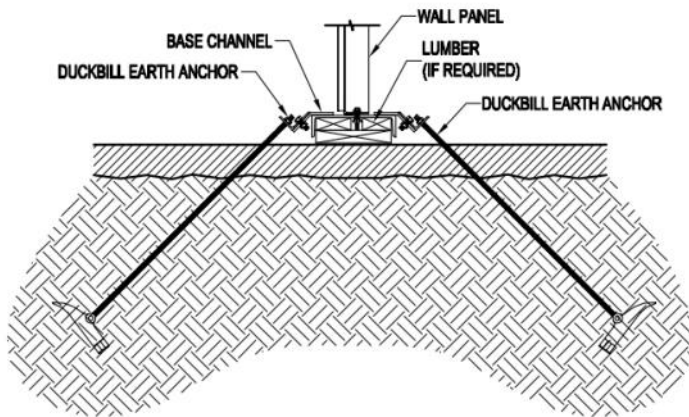

Building Installed on Existing Un-level Asphalt Surface
 Shimmed with Treated Wood Lumber

Steel Base Plate and Earth-Anchor Tie Down Foundation

Used for small and large buildings on existing grade enabling the building to withstand basic wind and snow loads.



Building Installs on Base Channel Similar to
 Installation on New Concrete

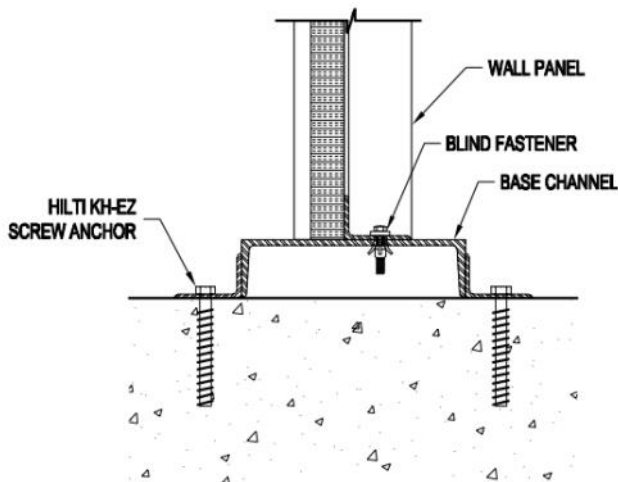

Steel Base Plate Anchored to Existing Slab

Used for buildings that are installed on uneven existing concrete or for frequently crane lifted buildings.



Finished Temporary Vehicle Inspection Enclosure for
 U.S. Customs and Border Patrol

Manta Ray earth anchors by Foresite Products, Inc. are driven tipping plate soil anchors for reaction of tensile loads. Manta Ray anchors have ultimate capacities up to 20 tons. After driving the anchor to the required depth, the driving tool (called drive steel) is removed. The anchor is then tipped and proof tested with Foresight's Anchor Locking Kit from its edgewise driving position to present its bearing area to the soil. This is called "load locking", and provides an immediate proof test of each anchor.

Manta Ray anchors offer many significant advantages:

- Fast, easy installation
- Immediate proof test results
- No grout
- Inexpensive installation equipment
- Environmentally friendly
- No excavation required



Manta-Ray Earth Anchor Heads

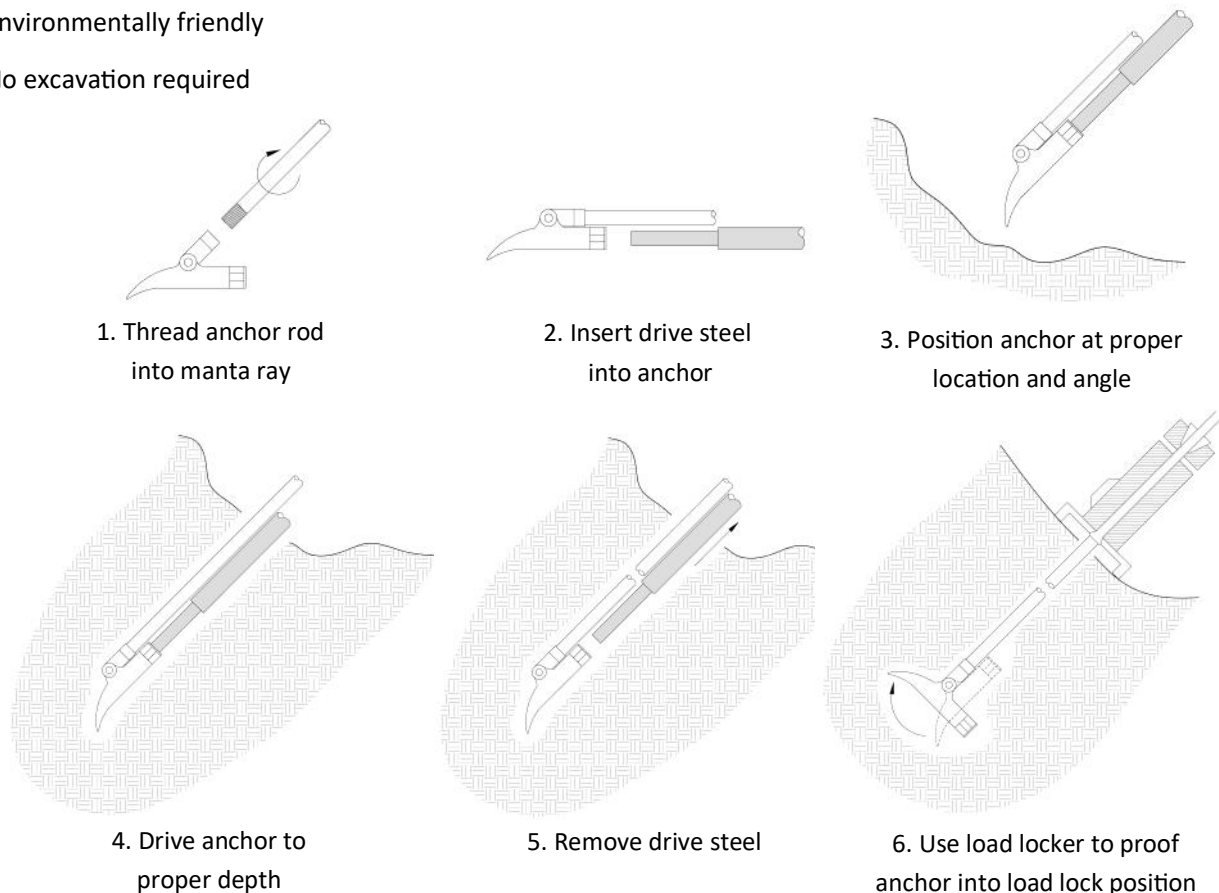

1. Thread anchor rod into manta ray

2. Insert drive steel into anchor

3. Position anchor at proper location and angle

4. Drive anchor to proper depth

5. Remove drive steel

6. Use load locker to proof anchor into load lock position

Earth Anchor Installation Procedure